



RECORD OWNER:
 MASSACHUSETTS
 AND REAL ESTATE TRUSTS

DEED REFERENCE:
 DEED BOOK 3024 PAGE 81 (DECLARATION OF TRUST)

FLOOD NOTE:
 THE PROPERTY IS LOCATED IN ZONE "X" OF THE FLOOD INSURANCE RATE MAP AS DEPICTED ON COMPLIANT PANEL NO. 25023 (0001), WHICH BEING AN SPECIAL FLOOD HAZARD ZONE.

- NOTES:**
1. THE LOCATION OF BUILDINGS, PATIO, BALCONIES, RETAINING WALLS AND WALKS SHOWN HEREON WERE COMPILED FROM APPROVED DESIGN PLANS.
 2. THE LOCATION OF BUILDINGS A, C, D, E, F, G, H, K, L, M AND N WERE COMPILED FROM RECORDED AS-BUILT CONSTRUCTION PLANS.
 3. BUILDING B, I AND J SHOWN HEREON IS THE RESULT OF AN AS-BUILT FIELD SURVEY.
 4. PERFORMED BY MERRILL CORPORATION BETWEEN JUNE 21, 2014 AND OCTOBER 1, 2014.
 5. EXISTING ENCLOSURES WERE NOT SHOWN FOR THE PURPOSE OF THIS PLAN.
 6. SEE AS-BUILT FLOOR PLANS ON SHEETS 9 AND 3 FOR INTERIOR LIFT DIMENSIONS.
 7. PHASE 9-B AND J INCLUDES UNITS B-10, B-12, B-13A AND B-14 WITHIN BUILDING B AND UNITS J-04, J-07 AND J-09 WITHIN BUILDING J.

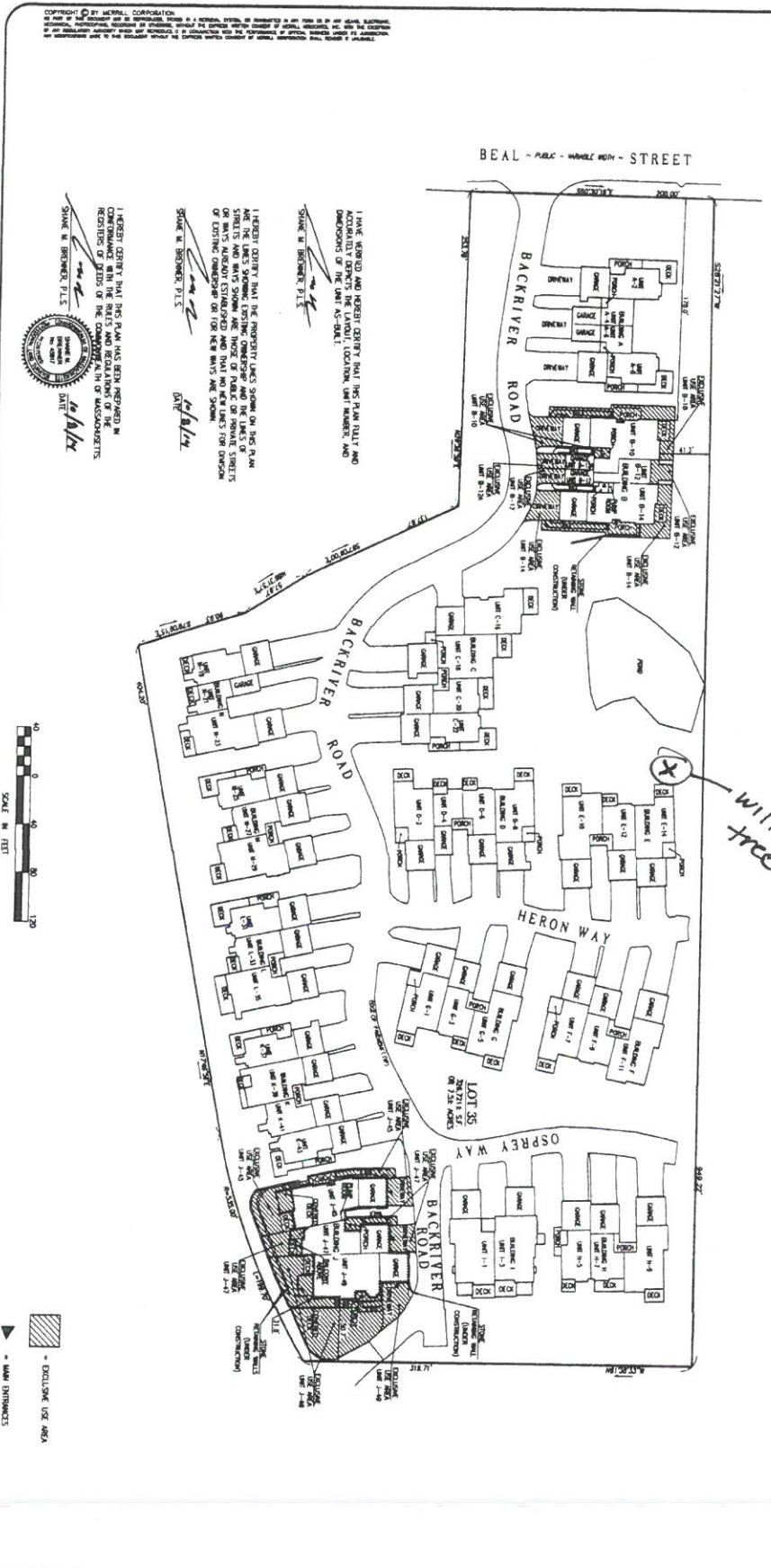

I HAVE VERIFIED AND HEREBY CERTIFY THAT THE PLAN TITLY AND DIMENSIONS OF THE UNIT SHOWN.

I HEREBY CERTIFY THAT THE PROPERTY LINES SHOWN ON THIS PLAN CORRESPOND TO THE LINES SHOWN ON THE RECORDS OF THE MASSACHUSETTS DEPARTMENT OF REVENUE AND THE LINES OF THE RECORDS OF THE MASSACHUSETTS DEPARTMENT OF REVENUE AND THE LINES OF THE RECORDS OF THE MASSACHUSETTS DEPARTMENT OF REVENUE.



RECORDED BY: SMB
 DESIGNED BY: SMB
 DRAWN BY: SMB
 CHECKED BY: SMB

14-578

RECORDED BY: SMB
 OCT 17 2014
 10:17 AM
 RECORDED

CONDOMINIUM SITE PLAN
 BACK RIVER CONDOMINIUM
 PHASE 9 - B AND J
 ASSESSORS MAP 57 LOT 35 - BEAL STREET
 HINGHAM, MASSACHUSETTS

DRIVER: BACK RIVER CONDOMINIUM TRUST
 18 BACK RIVER ROAD
 HINGHAM, MA 02043

OCTOBER 6, 2014
 SCALE: 1" = 40'
 JOB NO. 13-136
 LIST REVISION:

PHASE 9-B AND J
 CONDOMINIUM
 SITE PLAN
 SHEET 1 OF 3

Merrill
 Engineers and Land Surveyors
 427 Columbia Road, Hanover, MA 02339
 Telephone: 781-826-5200 Fax: 781-826-6665

14-578

916 #