

QUINNT K:\2871-19.01 HINGHAM MARINA PERMITS\CADD\PERMIT DWGS\NOI\PREVIOUS\287119.01 NOI-01 LOCUS MAP.DWG Jan 12, 2021 - 3:20pm



34 WILLIAM WAY, BELLINGHAM, MA 02019 U.S.A.
Phone: (508) 966-9092 E-mail: mail@childseng.com

Designed by:	SSS	Date:	01/12/21
Down by:	TEQ	Ckd by:	SSS
Reviewed by:	CMR	Design file no.:	287119.01 NOI-01
		Scale:	NONE

HINGHAM MARINA RECONFIGURATION
26 SUMMER STREET
HINGHAM, MA

LOCUS MAP

Sheet reference number:
NOI-01
Sheet 1 of 3

NOTES:

- 1) HISTORIC MEAN LOW WATER IS SHOWN ON THIS PLAN PER A PLAN ENTITLED "BOSTON HARBOR, MASSACHUSETTS" PUBLISHED APRIL 1901 BY THE US COAST AND GEODETIC SURVEY (DATE OF FIRST PUBLICATION 1867). SAID LINE AGREES WITH THE PRESUMPTIVE HISTORIC MEAN LOW WATER LINE PROVIDED BY THE MASSACHUSETTS DEPARTMENT OF ENVIRONMENTAL PROTECTION. THE PRESUMPTIVE HISTORIC MEAN HIGH WATER LINE SHOWN HEREON AS PROVIDED BY THE MASSACHUSETTS DEPARTMENT OF ENVIRONMENTAL PROTECTION.
- 2) PARCEL D, AS SHOWN ON THE PLAN RECORDED IN THE PLYMOUTH COUNTY REGISTRY OF DEEDS IN PLAN BOOK 10, PAGE 57, WAS CONVEYED IN 1954 TO GEORGE E. KIMBALL & SON INC. FROM JAMES H. KIMBALL IN A DEED RECORDED IN BOOK 2367, PAGE 172 IN SAID REGISTRY. SAID DEED STATES THAT THE PARCEL IS CONVEYED WITH "ANY RIGHTS IN HINGHAM HARBOR, SO FAR AS SAME ARE NOW IN FORCE OR APPLICABLE". SAID RIGHTS CONTINUED TO BE CONVEYED IN SUBSEQUENT DEEDS FOR SAID PARCEL D UP TO THE CURRENT DEED, RECORDED IN SAID REGISTRY IN BOOK 37624, PAGE 267.
- 3) PARCEL A, AS SHOWN ON SAID PLAN, WAS CONVEYED IN 1970 TO MOBIL OIL CORPORATION FROM EDWARD J. ZIEGLER AND RICHARD L. WILDER IN A DEED RECORDED IN SAID REGISTRY IN BOOK 3571, PAGE 757. SAID DEED CALLS OUT THE NORTHWESTERLY COURSE OF SAID PARCEL A AS "BY OTHER LAND NOW OR FORMERLY OF GRANTOR".
- 4) THIS DOCUMENT IS AN INSTRUMENT OF SERVICE OF HARRY R. FELDMAN, INC. ISSUED TO OUR CLIENT FOR PURPOSES RELATED DIRECTLY AND SOLELY TO HARRY R. FELDMAN INC.'S SCOPE OF SERVICES UNDER CONTRACT TO OUR CLIENT FOR THIS PROJECT. ANY USE OR REUSE OF THIS DOCUMENT FOR ANY REASON BY ANY PARTY FOR PURPOSES UNRELATED DIRECTLY AND SOLELY TO SAID CONTRACT SHALL BE AT THE USER'S SOLE AND EXCLUSIVE RISK AND LIABILITY, INCLUDING LIABILITY FOR VIOLATION OF COPYRIGHT LAWS, UNLESS WRITTEN CONSENT IS PROVIDED BY HARRY R. FELDMAN, INC.
- 5) UNLESS OTHERWISE NOTED, DETAILS ARE NOT TO SCALE.
- 6) COORDINATES SHOWN HEREON REFER TO MASSACHUSETTS STATE PLANE, MAINLAND ZONE (NAD83).

D
C
B
A

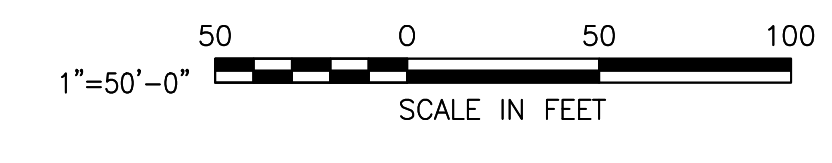
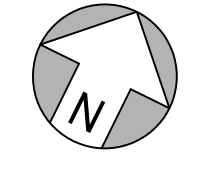
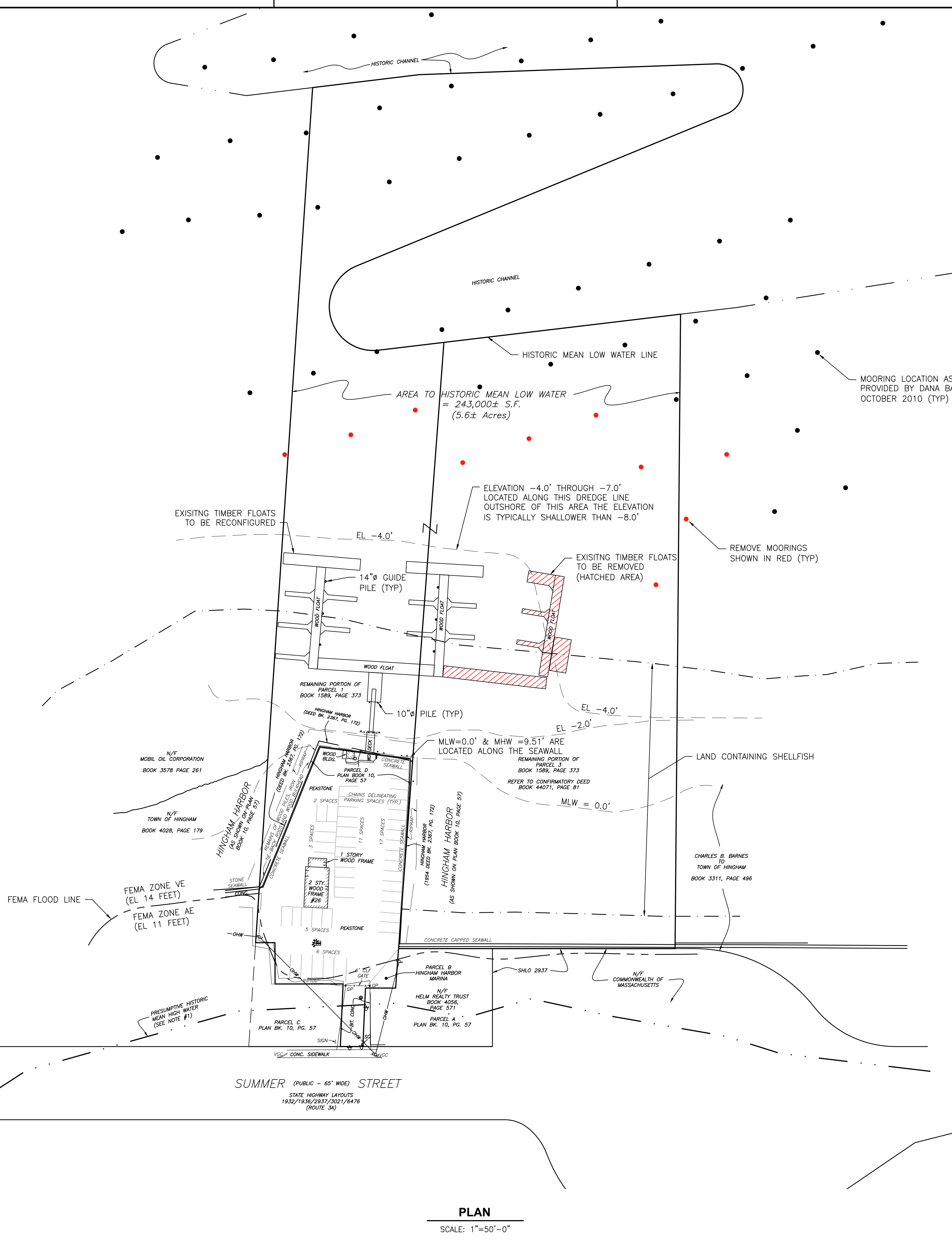

PLAN
SCALE: 1"=50'-0"

LEGEND:

	UTILITY POLE
	LIGHT POLE
	OBSERVATION WELL
	CATCH BASIN
	WATER METER
	WATER SHUT OFF
	GAS SHUT OFF
	SHUT OFF
	GATE POST
	10 INCH DIAMETER PILE
	14 INCH DIAMETER GUIDE PILE
	ENTRANCE
	CONCRETE
	VERTICAL GRANITE CURB
	CHAIN LINK FENCE
	DRILL HOLE
	STONE BOUND/DRILL HOLE
	MASSACHUSETTS HIGHWAY BOUND
	FOUND
	NOW OR FORMERLY
	SQUARE FEET
	BOOK
	PAGE
	RECORD
	CALCULATED
	STATE HIGHWAY LAYOUT
	RAILROAD SPIKE
	WOOD
	FENCE
	GUARD RAIL
	OVERHEAD WIRES

CHILDS ENGINEERING

34 WILLIAM WAY, BELLINGHAM, MA 02019 U.S.A.
 Phone: (508) 966-9092
 E-mail: mail@childseng.com

Mark	Date	Appr

Designed by:	SSS	Date:	01/12/21
Drawn by:	TEC	Design file no.:	3871801-WI-02
Reviewed by:	CNR	Scale:	1"=50'-0"

HINGHAM MARINA RECONFIGURATION
 26 SUMMER STREET
 HINGHAM, MA
EXISTING SITE/DEMOLITION PLAN

