

PLANT_SCHEDULE

DECIDUOUS TREES	QTY	BOTANICAL / COMMON NAME	CONT	CAL	SIZE
ACE RUB	10	ACER RUBRUM 'RED SUNSET' / RED SUNSET MAPLE	B & B	2" CAL.	12' HGT. MIN.
GLE TRI	6	GLEDTISIA TRIACANTHOS INERMIS / THORNLESS COMMON HONEYLOCUST	B & B	2" CAL.	12' HGT. MIN.
PLA XLP	6	PLATANUS X ACERIFOLIA / LONDON PLANE TREE	B & B	2" CAL.	12' HGT. MIN.
EVERGREEN TREES	QTY	BOTANICAL / COMMON NAME	CONT	CAL	SIZE
JUN VIR	22	JUNIPERUS VIRGINIANA / EASTERN RED CEDAR	B & B		5-6' HGT.
PIN STR	7	PINUS STROBUS / WHITE PINE	B & B		7-8' HGT.
TSU CAN	17	TSUGA CANADENSIS / CANADIAN HEMLOCK	B & B		6-7' HGT.
THU ACC	14	THUJA ACCIDENTALIS / ARBORVITAE	B & B		5-6' HGT.
FLOWERING TREES	QTY	BOTANICAL / COMMON NAME	CONT	CAL	SIZE
COR FLO	3	CORNUS FLORIDA / EASTERN DOGWOOD	B & B	2" CAL.	
PYR CAL	5	PYRUS CALLERYANA 'CHANTICLEER' / CHANTICLEER PEAR	B & B	2" CAL.	12' HGT. MIN.
GROUND COVERS	QTY	BOTANICAL / COMMON NAME	CONT	SIZE	SPACING
NE CON	4,959 SF	N.E. CONSERVATION / WILDLIFE MIX / LOAM, FINE GRADE & SEED	SEED		

LOCATION	DEPTH	DESCRIPTION
GENERAL PLANTING BEDS	6"	1/3 PEAT - MANURE BLEND 1/3 HIGH ORGANIC LOAM 1/3 EXISTING SOIL
FLOWER BEDS	6"	SCREENED LOAM 1/3 PEAT - MANURE BLEND LIME - PELATIZED OR GROUND (50 LB. PER 100 SF.) GROUND BONE MEAL (50 LB. PER 100 SF.) 10-10-10 INORGANIC FERTILIZER (50 LB. PER 5000 SF.)
LAWNS - SOG & SEED	6"	6" SCREENED LOAM
PITS/TREE WELLS "STANDARD MIX" FOR BACKFILL	12"	SOIL MIX 'A' - 1/3 PEAT - MANURE BLEND 1/3 HIGH ORGANIC LOAM 1/3 EXISTING SOIL
PITS/TREE WELLS "LITE WEIGHT MIX"	12"	SOIL MIX 'B' - 70% LIGHT WEIGHT SHALE 20% SAND 10% COMPOST
PITS/TREE WELLS "STRUCTURAL MIX"	12"	SOIL MIX 'C' - MIX COMPOSITION TO BE SUPPLIED BY LANDSCAPE ARCHITECT.

2 SCHEDULE OF TOPSOILS & ADDITIVES

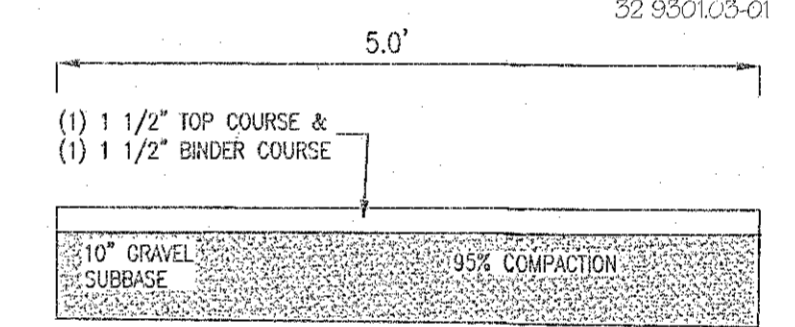

SIDEWALK DETAIL
(NOT TO SCALE)

- NOTES:**
ON TREES BELOW 3" CAL. USE WOOD STAKES.
ON TREES 3" CAL. OR GREATER USE GUYING CABLES.
IF GUYING CABLES USE 5 PER TREE
- INSTALL TREE PLUMB - L.A. TO APPROVE FACE / ORIENTATION OF TREES ON SITE
 - NON-GURDELING STRAP SUCH AS CHAIN LOCK OR ARBORITAPE
 - INSTALL TREE GATORS ON ALL TREES NOT COVERED BY IRRIGATION AS PER MANUFACTURER'S SPECIFICATIONS. CONTRACTOR TO MAINTAIN DURING PERIOD OF WARRANTY
 - TREE SHALL BE PLANTED 3" ABOVE SURROUNDING GRADE - TREE SHALL BE PLUMB AFTER SETTLEMENT
 - IF ROOTBALL IS WRAPPED IN PLASTIC OR NON-BIODEGRADABLE MATERIAL REMOVE ENTIRE WRAP - IF WRAPPED IN BURLAP, CUT OPEN AT LEAST 1/3 OF TOP
 - 3" PINE BARK MULCH (UNLESS OTHERWISE NOTED ON PLANS)
 - HAND EXCAVATE HOLE TO DIAMETER 2X WIDER THAN ROOT BALL - PRUNE ROOT FLARE - BACKFILL HOLE WITH PLANTING SOIL MIX AS SPECIFIED
 - EARTH SAUCER TO CONTAIN 3" MULCH - PULL MULCH 3-6" AWAY FROM TRUNK OF TREE (KNOCKDOWN/REMOVE SAUCER AFTER FIRST SEASON)
 - USE 2"x2" HARDWOOD STAKE (FOR BELOW 3" CAL.)
 - UNDISTURBED SUBGRADE
- NOTE:**
FOR ALL FALL PLANTING, WRAP TRUNK AS SPECIFIED TO 2ND LOWEST BRANCH - REMOVE THE FOLLOWING SPRING
- ALL TREES SHALL BE FLOODED TWICE DURING THE FIRST 24 HOURS AFTER PLANTING**
- PLANTING SOIL MIX:**
1/3 PEAT - BLEND MANURE
1/3 HIGH ORGANIC LOAM
1/3 EX. SOIL

1 SHADE / FLOWERING TREE DETAIL

REVISIONS

4/22/21	PLANNING/BOH REVIEW COMMENTS
4/29/21	PLANNING/BOH REVIEW COMMENTS
6/28/21	PLANNING/BOH REVIEW COMMENTS
8/12/21	PLANNING BOARD COMMENTS

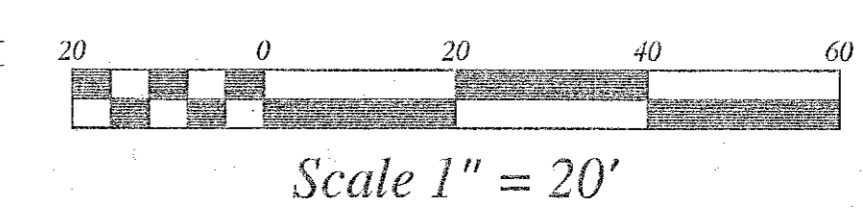

FOR REGISTRY USE ONLY

I, CAROL FALVEY, CLERK OF THE TOWN OF HINGHAM, HEREBY CERTIFY THAT THE NOTICE OF APPROVAL OF THIS PLAN BY THE PLANNING BOARD HAS BEEN RECEIVED AND RECORDED AT THIS OFFICE AND NO NOTICE OF APPEAL WAS RECEIVED DURING THE TWENTY DAYS NEXT FOLLOWING SUCH RECEIPT AND RECORDING OF SAID NOTICE.

DATE: _____ TOWN CLERK
APPROVED: _____ SUBJECT TO COVENANT CONDITIONS SET FORTH IN A COVENANT EXECUTED BY: _____ DATED: _____ AND TO BE RECORDED HERewith.

APPROVAL UNDER SUBDIVISION CONTROL LAW IS REQUIRED
DATE SUBMITTED: _____
DATE APPROVED: _____
DATE ENDORSED: _____

HINGHAM PLANNING BOARD
DATE SUBMITTED: _____
DATE APPROVED: _____
DATE ENDORSED: _____

HINGHAM BOARD OF HEALTH
DATE SUBMITTED: _____
DATE APPROVED: _____
DATE ENDORSED: _____

I DO HEREBY CERTIFY THAT THE SUBDIVISION AS SHOWN HEREON CONFORMS WITH THE TOWN OF HINGHAM PLANNING BOARD SUBDIVISION RULES & REGULATIONS EXCEPT FOR THE WAIVERS AS REQUESTED.



KG
KEVIN GRADY, P.E.
DATE: 11/17/21

I HEREBY CERTIFY THAT THIS PLAN HAS BEEN PREPARED IN CONFORMANCE WITH THE RULES AND REGULATIONS OF THE REGISTER OF DEEDS OF THE COMMONWEALTH OF MASSACHUSETTS.

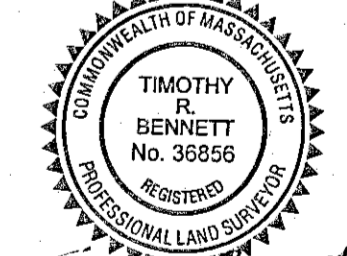

T.R.B.
TIMOTHY R. BENNETT P.L.S. #38856
DATE: 11/17/21

LANDSCAPE PLAN
DEFINITIVE SUBDIVISION PLAN
#101 GARDNER STREET
HINGHAM, MASSACHUSETTS

PREPARED FOR:
Ms. CHRISTINE WALKER, CONTROLLER
BOSTON GOLF CLUB
#19 OLD COUNTY ROAD
HINGHAM, MA 02043

FEBRUARY 26, 2021
SCALE: AS SHOWN
JOB No. 20-164

GRADY CONSULTING, L.L.C.
Civil Engineers, Land Surveyors & Landscape Architects
71 Evergreen Street, Suite 1, Kingston, MA 02364
Phone (781) 585-2300 Fax (781) 585-2378