

WALL TYPES	
E	EXISTING WALL TO REMAIN NEW PAINT OR F.R.P. FINISH SEAL ALL VOIDS AT ROOF TO WALL CONNECTIONS
E1	INTERIOR WALL TO MATCH ADJACENT CONSTRUCTION SEAL ALL VOIDS AT ROOF TO WALL CONNECTIONS
1	3 5/8" METAL STUD AT 16" O.C. BRACED ABOVE CLC TO STRUCTURE 5/8" CIP. BD. ON EACH SIDE OF STUD F.A.S. FINISH
2	3 5/8" METAL STUD AT 16" O.C. BRACED ABOVE CLC TO STRUCTURE 5/8" CIP. BD. ON EACH SIDE OF STUD PAINT FINISH
3	8" CMU WALL EXTEND TO UNDERSIDE OF STRUCTURE ABOVE F.R.P. OR PAINT FINISH
4	3 5/8" METAL STUD AT 16" O.C. BRACED ABOVE CLC TO STRUCTURE 5/8" CIP. BD. ON EACH SIDE OF STUD F.A.S. FINISH

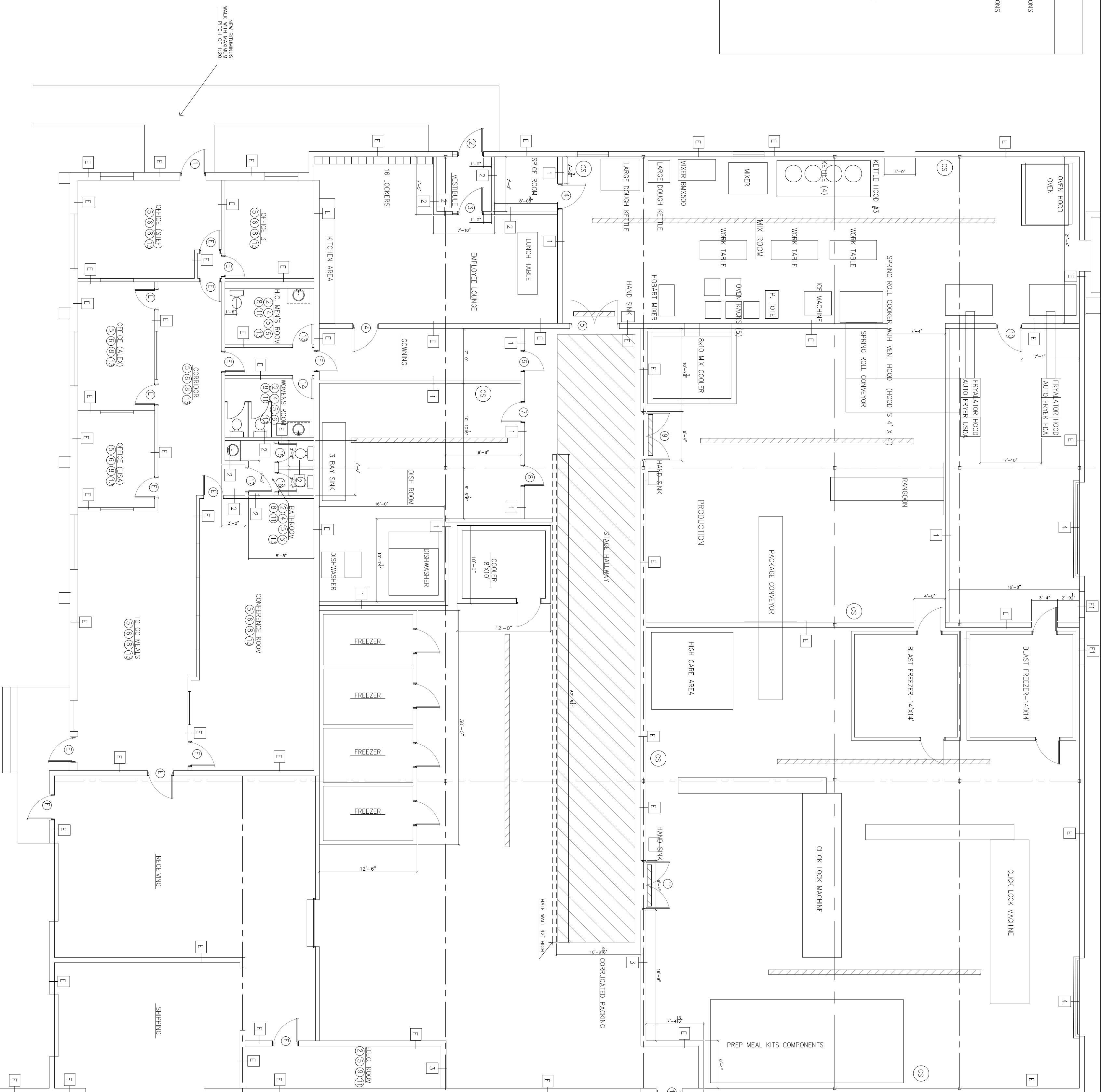

**A FLOOR PLAN**  
1/8" = 1'-0"

- PLAN NOTES:
- NEW EXTERIOR DOOR: TO MATCH EXISTING.
  - PATCH CONCRETE SLAB AND FILL ALL VOIDS.
  - PATCH CONCRETE FLOOR LIGHT GREY.
  - REMOVE PLUMBING FIXTURES AND TERMINATE ALL PLUMBING BELOW THE SLAB.
  - PATCH GYPSUM WALL BOARD AT WALLS AND CEILING, MAINTAIN FIRE RATINGS.
  - PAINT ALL INTERIOR WALLS OFF-WHITE.
  - REMOVE ALL ELECTRICAL DEVICES AND TERMINATE WIRING BACK TO ELECTRICAL PANEL.
  - INSTALL NEW CEILING TILE AND GRID AT SAME HEIGHT.
  - INSTALL NEW CEILING TILE AND GRID AT 10'-0" A.F.F.
  - INSTALL NEW CEILING TILE AND GRID AT 11'-0" A.F.F.
  - INSTALL NEW PLUMBING FIXTURES.
  - REMOVE ALL CABINETRY AND COUNTERTOPS.
  - REMOVE ALL FLOORING AND ADHESIVES AND INSTALL NEW FLOORING.

DOOR SCHEDULE											
DOOR NUMBER	WIDTH	HEIGHT	THICKNESS	TYPE	MATERIAL	FRAME	FINISH	MATERIAL	HARDWARE SET	REMARKS	
1	3'-0"	6'-8"	1 3/4"	B	INSUL. MTL.	METAL	PAINT	METAL	EXTENSION LOCKSET	CARD READER ACCESS	
2	3'-0"	6'-8"	1 3/4"	B	INSUL. MTL.	METAL	PAINT	METAL	EXTENSION LOCKSET	CARD READER ACCESS	
3	3'-0"	6'-8"	1 3/4"	A	METAL	METAL	PAINT	METAL	PUSH / PULL		
4	3'-0"	6'-8"	1 3/4"	A	METAL	METAL	PAINT	METAL	STOREROOM		
5	(2)3'-0"	6'-8"	1 3/4"	A	METAL	METAL	PAINT	METAL	PUSH / PULL	CARD READER ACCESS	
6	3'-0"	6'-8"	1 3/4"	A	METAL	METAL	PAINT	METAL	PUSH / PULL		
7	3'-0"	6'-8"	1 3/4"	A	METAL	METAL	PAINT	METAL	PUSH / PULL		
8	3'-0"	6'-8"	1 3/4"	A	METAL	METAL	PAINT	METAL	PUSH / PULL	CARD READER ACCESS	
9	(2)3'-0"	6'-8"	1 3/4"	A	METAL	METAL	PAINT	METAL	PUSH / PULL	CARD READER ACCESS	
10	3'-0"	6'-8"	1 3/4"	A	METAL	METAL	PAINT	METAL	PUSH / PULL	CARD READER ACCESS	
11	(2)3'-0"	6'-8"	1 3/4"	A	INSUL. MTL.	METAL	PAINT	METAL	EXTENSION LOCKSET	CARD READER ACCESS	
12	3'-0"	6'-8"	1 3/8"	C	WOOD	WOOD	PAINT	WOOD	PUSH / PULL		
13	3'-0"	6'-8"	1 3/8"	C	WOOD	WOOD	PAINT	WOOD	PUSH / PULL		
14	3'-0"	6'-8"	1 3/8"	C	WOOD	WOOD	PAINT	WOOD	PUSH / PULL		
15	2'-4"	6'-8"	1 3/8"	C	WOOD	WOOD	PAINT	WOOD	PRIVACY LATCH		
16	2'-4"	6'-8"	1 3/8"	C	WOOD	WOOD	PAINT	WOOD	PRIVACY LATCH		
17	3'-0"	6'-8"	1 3/8"	C	WOOD	WOOD	PAINT	WOOD	PUSH / PULL		
18	3'-0"	6'-8"	1 3/8"	C	WOOD	WOOD	PAINT	WOOD	PRIVACY LATCH		

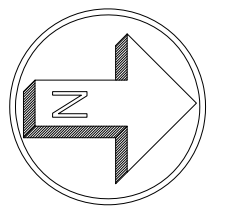
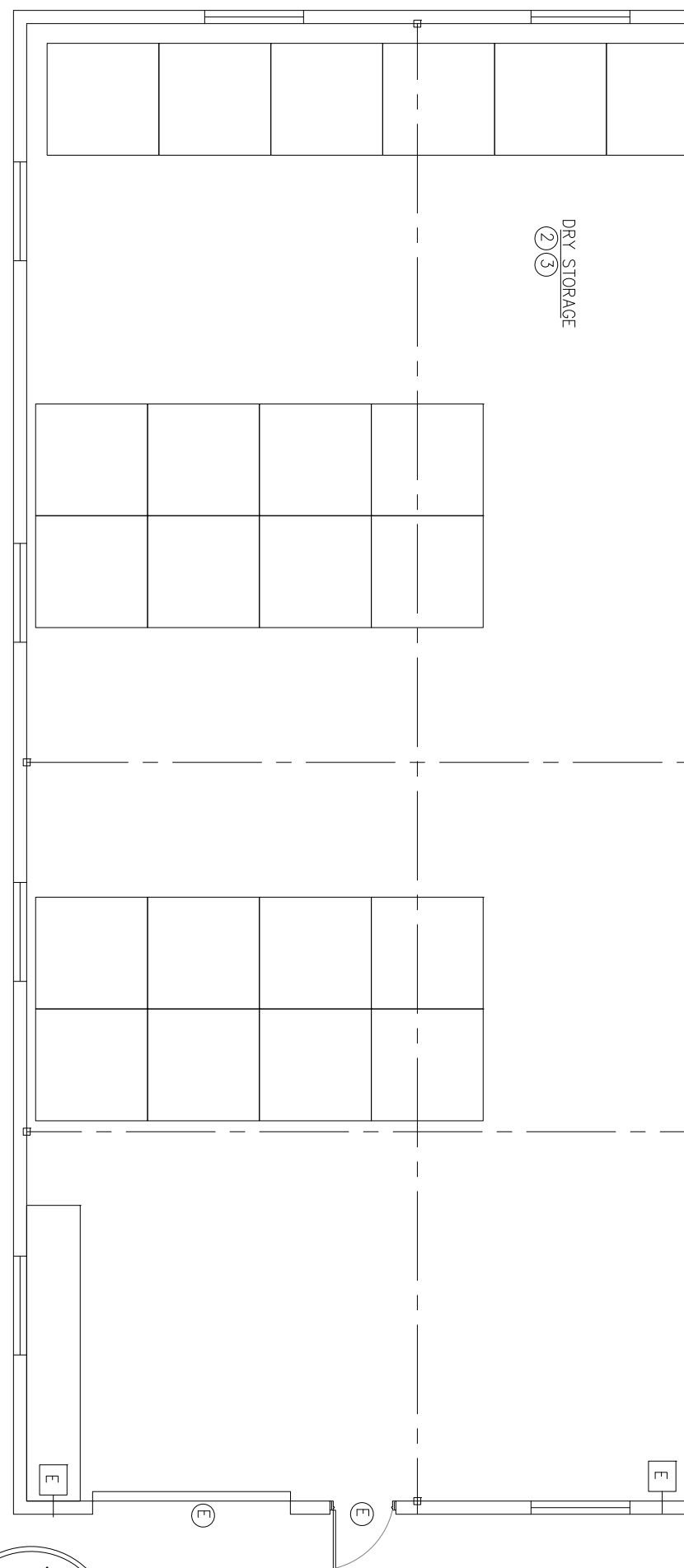

Copyright © 2010 by DS design Architects. The architectural plans, drawings, designs, specifications and other arrangements on this sheet are and shall remain the property of DS design Architects. No part thereof shall be copied, disclosed to others, or used in connection with any work or project, other than the specified project for which they have been prepared and developed, without the express knowledge and written consent of dsd Architects, Inc.

# FLOOR PLAN AND DEMOLITION PLAN

## YANKEE TRADER HEADQUARTERS

80 SHARP STREET  
HINGHAM, MA

**A.1**

Scale: AS NOTED  
Date: 8/9/19  
Drawn By:  
Checked By:  
Job Number: 201901

**DS design architects**

54 Cedar Road  
Marshfield, MA 02050  
Tel: 781-834-3942  
Fax: 781-834-3942  
email: dsdarch@gmail.com

Date	Revisions